

THE CHESTER

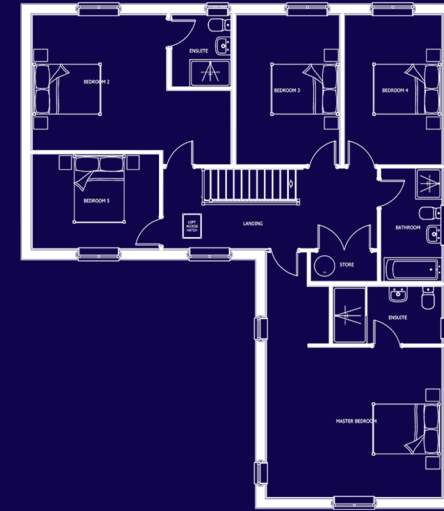
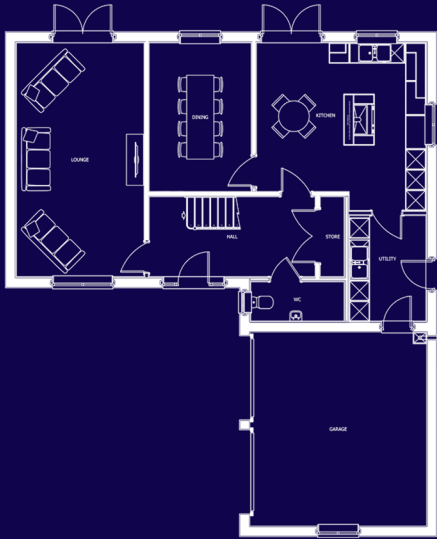

A Five bedroom home, perfect for families and professionals

LOUNGE	6.9 X 3.8	22'8 X 12'6
DINING	4.4 X 3.0	14'6 X 10'
WC	1.2 X 2.7	3'11 X 9'2
UTILITY	3.1 X 2.3	10'4 X 7'7
KITCHEN	4.4 X 5.0	14'6 X 16'6
GARAGE	5.7 X 5.1	18'9 X 17'1

M BEDROOM	4.4 X 5.1	14'8 X 17'1
ENSUITE	1.7 X 3.2	5'8 X 10'8
STORE	0.9 X 2.0	3' X 6'7
BATHROOM	3.3 X 1.8	11'1 X 6'1
BEDROOM 2	4.0 X 3.9	13'3 X 13'1
BEDROOM 3	4.4 X 3.0	14'7 X 10'
BEDROOM 4	4.4 X 2.9	14'7 X 9'7
BEDROOM 5	2.8 X 3.7	9'4 X 12'5



Please refer to your site map for plot numbers for this housetype. These dimensions are correct to within 50mm/2" but should not be used as a basis for the purchase of furnishings. Individual properties may vary from illustrations shown.